

Elevation C

LibertyHomesVA.com

The Jefferson

Renderings and Plans are for marketing purposes only and may be shown with additional options including siding. This information is deemed accurate, but cannot be guaranteed. Consult Sales Contract and Option Schedule for actual options chosen. Builder reserves the right to make changes at any time.

The Jefferson Optional Elevations

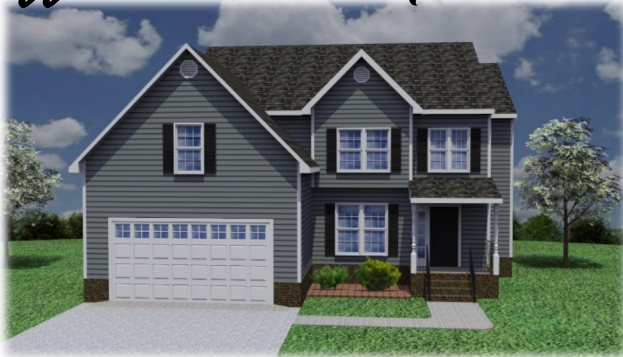

Elevation A



Elevation B

ADDITIONAL ELEVATIONS SHOWN W/ SHAKE, BOARD AND BATTEN, AND/OR ARCHITECTURAL GABLE ACCENTS



Elevation A

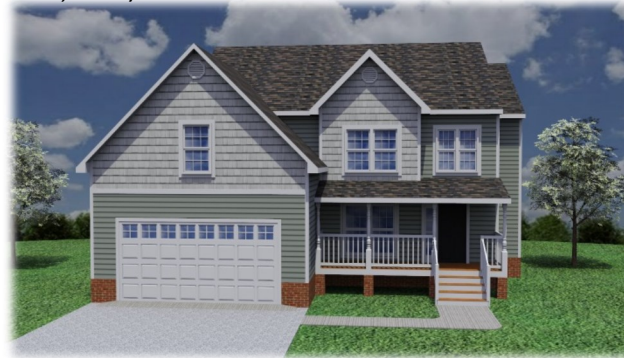

Elevation B



Elevation C



Elevation C

Renderings and Plans are for marketing purposes only and may be shown with additional options including siding. This information is deemed accurate, but cannot be guaranteed. Consult Sales Contract and Option Schedule for actual options chosen. Builder reserves the right to make changes at any time.

The Jefferson Floor Plan

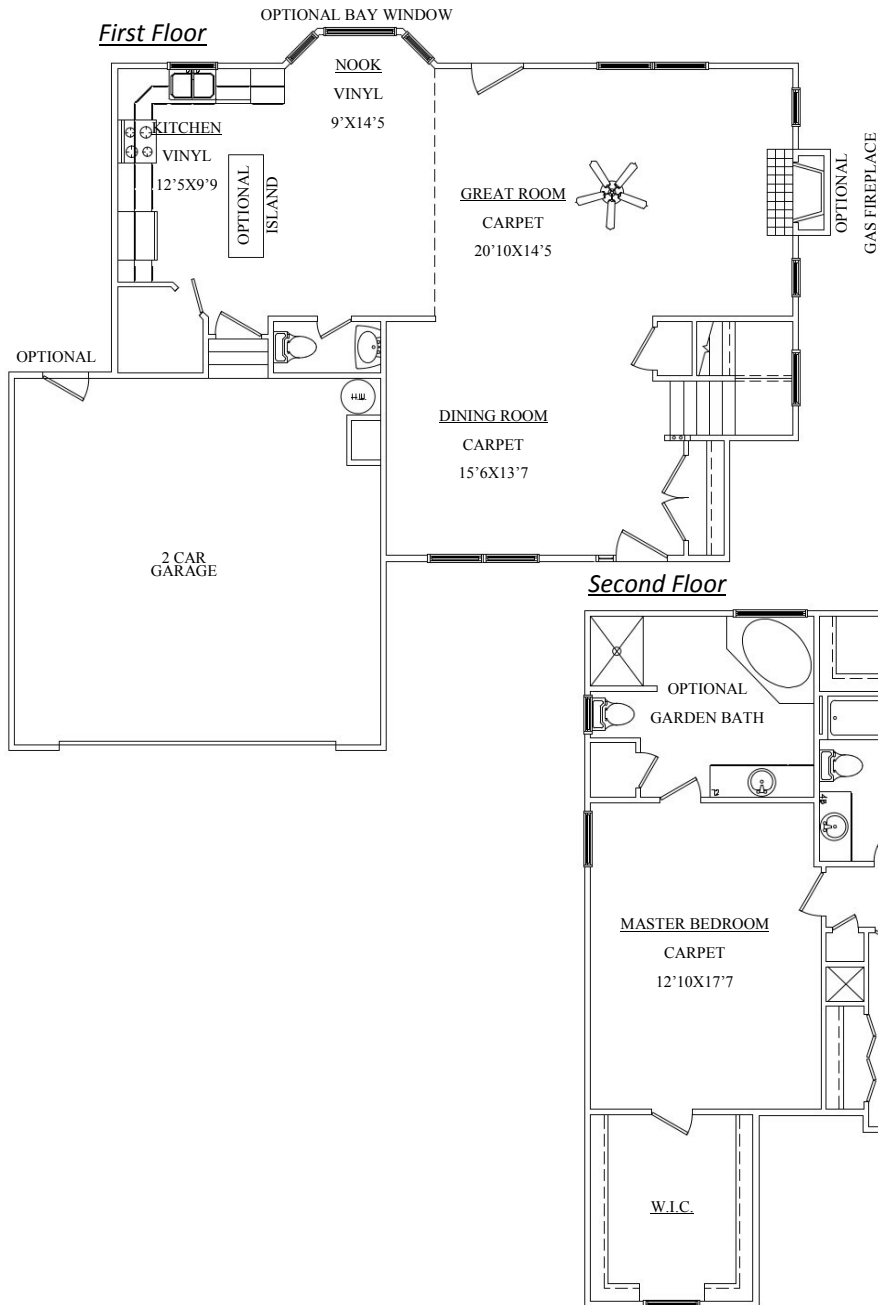

Liberty Homes, Inc.
8249 Crown Colony Parkway
Mechanicsville, VA 23116

Phone: (804) 730-7770
LibertyHomesVA.com



2218 Finished Square Feet
4BR/2.5BA
Optional Garden Bath
2 Car Garage

Renderings and Plans are for marketing purposes only and may be shown with additional options including siding. This information is deemed accurate, but cannot be guaranteed. Consult Sales Contract and Option Schedule for actual options chosen. Builder reserves the right to make changes at any time.